

Inductive proximity switches

IFRM 08 (short)

sample drawing

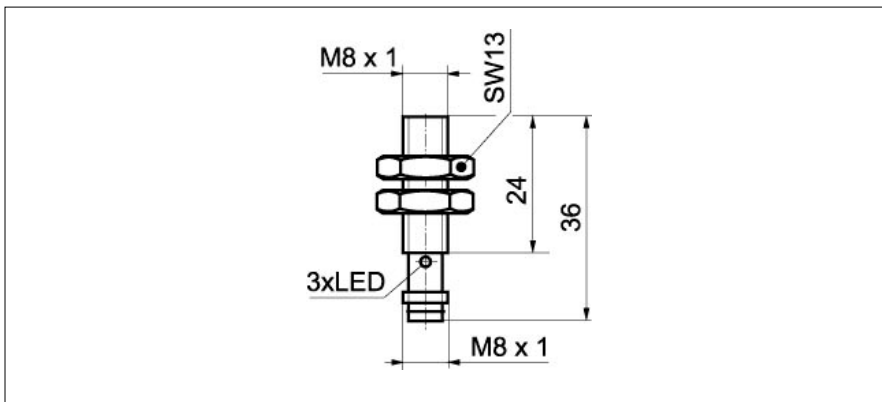

general data

mounting type	shielded
nominal sensing distance S_n	2 mm
hysteresis	3 ... 20 % of S_r

electrical data

switching frequency	< 5 kHz
voltage supply range +Vs	10 ... 30 VDC
current consumption max.	12 mA
voltage drop Vd	< 2 VDC
output current	< 200 mA
short circuit protection	yes
reverse polarity protection	yes

mechanical data

type	cylindrical threaded
material (sensing face)	PBT
housing material	stainless steel
dimension	8 mm

ambient conditions

operating temperature	-25 ... +75 °C
protection class	IP 67

sample picture



types available	connection types	output circuit	output function	housing length	output indicator
IFRM 08N1701/L	cable	NPN	NO	30 mm	LED red
IFRM 08N17A3/S35L	connector	NPN	NO	36 mm	3 port LED red
IFRM 08N3701/L	cable	NPN	NC	30 mm	LED red
IFRM 08N37A3/S35L	connector	NPN	NC	36 mm	3 port LED red
IFRM 08P1701/L	cable	PNP	NO	30 mm	LED red
IFRM 08P17A3/S35L	connector	PNP	NO	36 mm	3 port LED red
IFRM 08P3701/L	cable	PNP	NC	30 mm	LED red
IFRM 08P37A3/S35L	connector	PNP	NC	36 mm	3 port LED red